

SP关节轴承座 Spherical bearing housing



产品特性 Product features

- 从UC204到UC208
 - 标准耐磨材料EPB13球体
可选: FDA等级球体EPB6、高温250°C球体EPB10
 - 不锈钢基座带有2个固定孔
 - 自润滑免维护
 - 高负载
 - 耐脏污
- UC204 up to UC208
 - Standard anti-wear composite EPB13 balls
available FDA grade material EPB6 or 250°C material EPB10
 - Stainless steel housing with 2 mounting holes
 - Maintenance-free dry operation
 - High load
 - Resistant to dirt

标准规格 Standard specifications

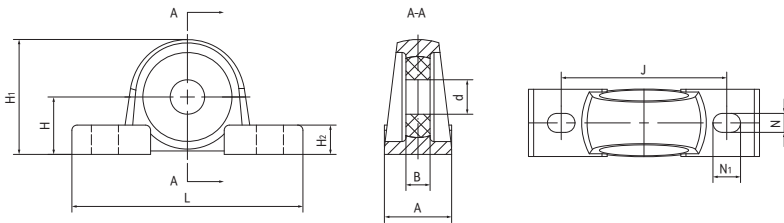

产品编码 Part No.:

SP204-20-17-EPB13

材料 Material

宽度 Width

内径 Inner diameter

产品编码 Part No.	d [mm]	d公差 Tolerance [mm]	B _{±0.1} [mm]	A [mm]	H [mm]	H ₁ [mm]	H ₂ [mm]	N [mm]	N ₁ [mm]	J [mm]	L [mm]	最大静态径向 抗压强度 Max. radial static compressive strength [KN]	最大静态轴向 抗拉强度 Max. axial static tensile strength [KN]	最大调 节角度 Max. pivot angle	重量 Weight [g]
SP204-20-17-EPB13	20	+0.040/+0.124	17	33	33.3	63	11	13	19	95	125	11.5	7.5	19°	284
SP205-25-17-EPB13	25	+0.040/+0.124	17	36	36.5	68	13	13	19	105	133	14.5	7.5	15°	339
SP206-30-19-EPB13	30	+0.040/+0.124	19	42	42.9	80	15	17	23	121	155	19.5	9.5	15°	522
SP207-35-20-EPB13	35	+0.050/+0.150	20	48	47.9	93	18	17	23	127	167	24.0	10.5	16°	800
SP208-40-21-EPB13	40	+0.050/+0.150	21	54	49.2	106	18	17	23	137	184	29.0	12.0	15°	1100